

TURNING POINTS of HISTORY

MALTA TO ISTANBUL

aboard *Variety Voyager* • June 1–13, 2016

CRITERION  travel



Along the shores of the Mediterranean Sea,

over thousands of years stretching back to antiquity, civilizations have met and mingled, religious and political views have been championed and enforced, trade routes have been coveted and claimed, and imperial political and military power struggles have fashioned and refashioned the map time and time again. This ten-night springtime cruise will explore the sites and events that have cumulatively left their mark on the geopolitical formations of the Mediterranean that we recognize today.

Concentrating on three major sites of conflict where the fate of empires has been decided, the program begins in the key area of the Mediterranean on the Malta/Sicily axis, central to the conflict between the Ottoman Empire and Christendom as well as to events that catapulted Rome ahead of the Athenian Empire as the major power of the western Mediterranean. On the western shoreline of modern Greece, consider events that ensured the Roman Empire's place as a western empire as well as measures that thwarted the Ottoman Empire's chances of expanding and ultimately led to an independent Greece. Finally, visit the Dardanelles and the site of Troy, where the first great clash between West and East was commemorated by Homer, ending in the crossroads city of Istanbul.

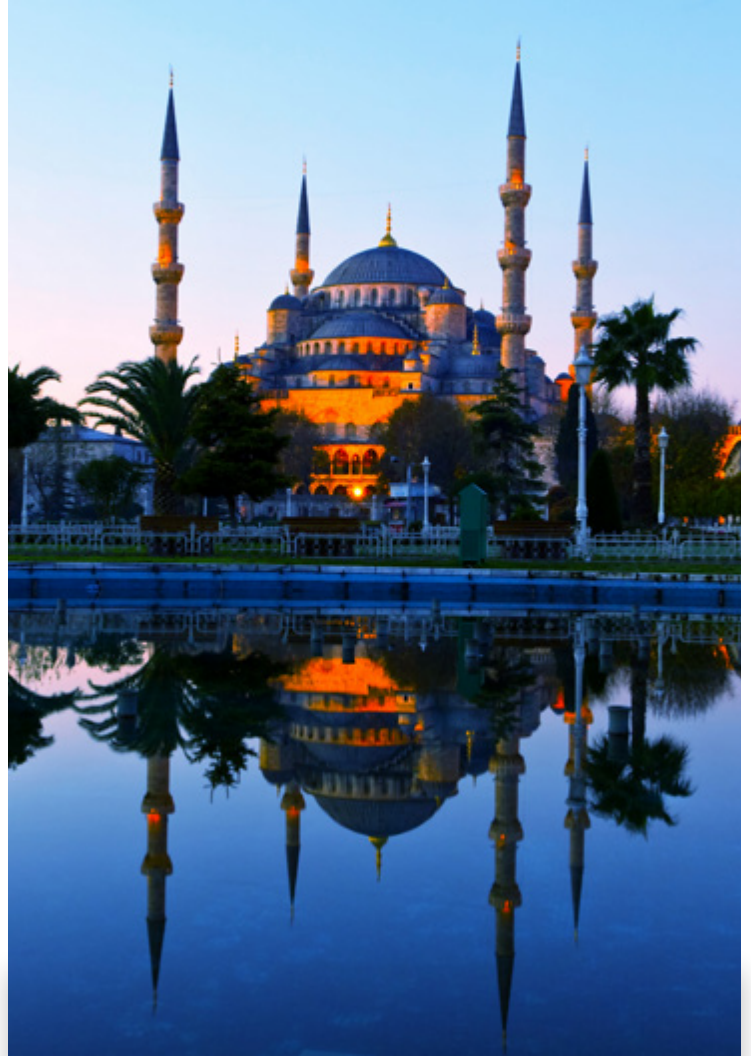

HIGHLIGHTS

Enjoy time throughout the cruise to learn about the significant cultural and historical turning points in the eastern Mediterranean region from our team of expert lecturers.

Visit four UNESCO World Heritage sites:

Valletta, the capital of Malta; Siracusa, a once-powerful threat to Athens; Delos, mythological birthplace of Apollo and Artemis; and Old Istanbul, replete with treasures.

Explore two fascinating museums: the

Nikopolis Museum, adjacent to the Nikopolis archaeological site, and the Acropolis Museum in Athens, built over an extensive archaeological site visible beneath a transparent floor.



ITINERARY

Wednesday & Thursday, June 1 & 2

HOME / VALLETTA, MALTA

Depart home on an overnight flight to Valletta. Upon arrival on June 2, check in to the Excelsior Hotel for a welcome orientation, reception, and dinner.

EXCELSIOR HOTEL (R,D)

Friday, June 3

VALLETTA (EMBARK)

Valletta, the capital of Malta and a UNESCO World Heritage site, was built by the Knights Hospitaller Order of St. John to defend against the Ottomans in the 16th century. Today, visit the baroque Co-Cathedral to see the knights' inlaid tombs; the Baptistery's masterpiece by Caravaggio, The Beheading of St. John the Baptist; and Fort St. Elmo, which withstood a 28-day assault by the Ottomans before falling during the Great Siege of Malta in 1565. Cross the harbor to Vittoriosa (Birgu) to explore the old fortified city that also played a crucial role in the Great Siege. Embark *Variety Voyager* in the late afternoon and gather for the captain's welcome reception and dinner.

VARIETY VOYAGER (B,L,D)

Saturday, June 4

SIRACUSA, SICILY

Once a powerful threat to the hegemony of Athens, Siracusa, a UNESCO World Heritage site, was founded around 734 B.C. by Greek Corinthians and subsequently

ruled by Romans, Saracens, Byzantines, Normans, and Ottomans. Take an excursion to the Archaeological Park's amphitheater and Ear of Dionysius limestone cave. On the island of Ortigia, which separates Siracusa's two harbors, visit the 6th-century B.C. Temple of Apollo, the cathedral, and the Arethusa Fountain. Enjoy a private wine tasting, as well as a private cheese-making lesson and tasting.

VARIETY VOYAGER (B,L,D)

Sunday, June 5

AT SEA

Relax on board ship during a full day at sea, with time to enjoy presentations by the lecture team.

VARIETY VOYAGER (B,L,D)

Monday, June 6

PREVEZA, GREECE

This morning disembark the ship in Preveza to delve into the historic Battle of Actium, the decisive naval engagement between Octavian and the combined forces of Mark Antony and Cleopatra in 31 B.C. Climb the promontory overlooking the battle site where the Roman navy's smaller and more nimble ships defeated Antony's 500 heavy galleys and sent Queen Cleopatra and her paramour scurrying for Alexandria and ignominy. Also explore the archaeological treasures from Roman and Early Christian times at the new Nikopolis Museum.

VARIETY VOYAGER (B,L,D)

Tuesday, June 7

PYLOS

Pylos, also known by its Italian name, Navarino, is the site of a decisive battle during the Greek War of Independence in 1827. In nearby Methoni, visit the castle, an impressive fortress separated from the mainland by a deep moat, where the Crusaders stopped en route from Venice to the Holy Land.

VARIETY VOYAGER (B,L,D)

Wednesday, June 8

DELOS

Spend the morning on the island of Delos, which is near the center of the Cyclades archipelago and is one of the most important mythological, historical, and archaeological sites in Greece. Designated in Greek mythology as the birthplace of Apollo and Artemis, Delos is a UNESCO World Heritage site, exceptionally rich in monuments, temples, and statues. This evening enjoy time at leisure on Mykonos, which buzzes with a vibrant nightlife.

VARIETY VOYAGER (B,L)

Thursday, June 9

ATHENS

Today is devoted to Athens. Visit the Acropolis and the Acropolis Museum, which opened in 2009. Because the museum is built over an extensive archaeological site, parts of the floor are transparent to allow visitors to view the ongoing excavations

below. The top level of the museum sits at an angle to the lower levels to replicate the orientation of the ancient temple on the Acropolis. Lunch is on your own, with time to explore the historic Plaka District.

VARIETY VOYAGER (B,D)

Friday, June 10
AT SEA

As the ship cruises to the Dardanelles, relax on board and enjoy the continuation of the lecture program.

VARIETY VOYAGER (B,L,D)

Saturday, June 11
CANAKKALE, TURKEY
(GALLIPOLI & TROY)

Dock in Canakkale, a seaport located at the narrowest point of the Hellespont (Dardanelles) Strait. Visit the battle elds and cemeteries at Gallipoli, where a brutal conflict took place between Allied and

Ottoman forces during World War I and where Kemal Ataturk forged his reputation as a defender of the Turkish motherland. Then continue to the Bronze Age site of ancient Troy, where the Achaeans defeated the Trojans in the 12th century B.C. to avenge Paris's kidnapping of Helen, Queen of Sparta—an event dramatically recounted in Homer's *Iliad*.

VARIETY VOYAGER (B,L,D)

Sunday, June 12
ISTANBUL

Discover the masterpieces of Old Istanbul (Sultanahmet), including many UNESCO World Heritage sites: the Hippodrome, center of Byzantine civic life; the splendid Sultan Ahmet Mosque, commonly called the Blue Mosque for its dazzling blue Iznik tiles; the breathtaking Hagi Sofia Basilica, the Eastern Roman Empire's beacon of Christianity until, in 1453, Sultan Mehmet

"The Conqueror" ended Byzantine reign in favor of the Ottomans; and Topkapi Palace and its lavishly decorated Imperial Harem, the primary residence of the Ottoman sultans for nearly 400 years. This evening celebrate your experience at the captain's farewell reception and dinner.

VARIETY VOYAGER (B,L,D)

Monday, June 13
ISTANBUL / HOME

Disembark *Variety Voyager* and transfer to the airport for flights home. (B)



VARIETY VOYAGER

The yacht *Variety Voyager*, launched in 2012, is an intimate vessel with just 36 cabins, designed to host small exclusive charters. Cabins range in size from 129 to 292 sq. ft. and are comfortably furnished. They feature en suite facilities, individually controlled air-conditioning, and TV/DVD. Throughout the ship, guests enjoy unobstructed views of the sea and the ports visited, and the services of a friendly crew of 28. There are opportunities to dine both inside and al fresco, and complimentary beer and wine are served with lunch and dinner. Public areas include a partly shaded sundeck lounge bar, a library, and a mini-spa with massage room, sauna, steam room, and tness equipment. There is an Internet Corner and access to 24-hour Wi-Fi in the lounge.

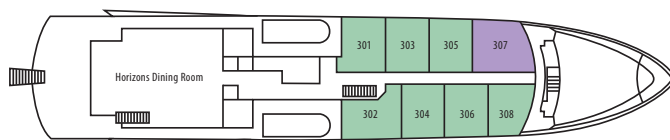
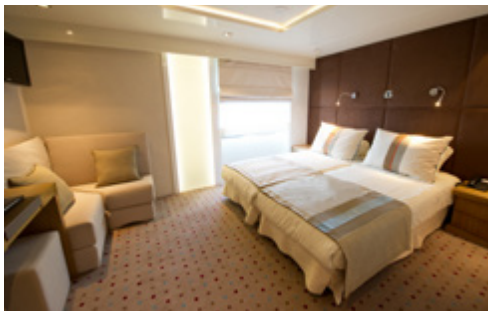

HORIZONS DECK

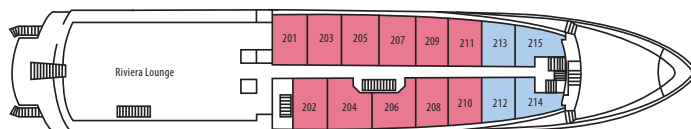

RIVIERA DECK

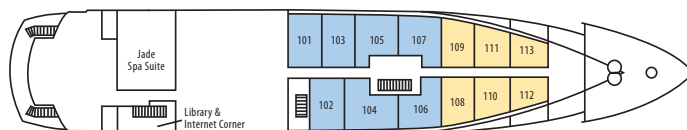

MARINA DECK

PROGRAM RATES (per person)

Category	DOUBLE	SINGLE
C	\$8,995	\$13,495
MARINA DECK 129-145 sq. ft. depending on location, twin portholes, twin beds or queen bed, shower		
B	\$9,995	\$14,995
MARINA DECK & RIVIERA DECK 145-216 sq. ft. depending on location, twin portholes (Marina Deck) or double windows (Riviera Deck), twin beds or queen bed (7 of the 11 cabins offer flexible bedding configuration), shower		
A	\$10,995	—
RIVIERA DECK 151-195 sq. ft. depending on location, double windows, twin beds or queen bed (9 of the 11 cabins offer flexible bedding configuration), shower		
P	\$12,395	—
HORIZONS DECK 227-248 sq. ft. depending on location, double windows, twin beds or queen bed (all cabins offer flexible bedding configuration and 4 of the 7 include an extra sofa bed), shower		
O	\$13,995	—
HORIZONS DECK Owner's Suite 292 sq. ft., four windows, twin beds or queen bed (flexible bedding configuration), shower		

Program Rates Include

All accommodations and meals as specified in the itinerary • All excursions as specified in the itinerary • Full program of briefings, lectures, and presentations • Individual or group transfers for all participants on group arrival and departure days • Baggage handling • Gratuities to porters, wait staff, guides, drivers, and shipboard personnel • Entrance fees • Welcome and farewell wine receptions • Wine, beer, and soft drinks with group lunches and dinners and aboard *Variety Voyager* • Bottled water on motorcoaches • Professional tour manager



To reserve a place on **Turning Points of History** please complete and return this form with your deposit of \$1,000 per person, payable to Criterion Travel. Mail to: 145 Forest Ave. Palo Alto, CA 94301. For more information or to reserve by phone, please call (888) 328-2089 or (650) 328-2089, or email res@critteriontravel.com

GENERAL INFORMATION

PROGRAM RATES DO NOT INCLUDE

U.S. domestic and international airfare • Passport/visa expenses • Medical expenses and immunizations • Travel insurance • Optional excursions or deviations from the scheduled tour • Private or independent transfers between the airport and hotel/ship other than arranged group transfers • Excess baggage charges • Meals not specified in the itinerary; dishes and beverages not part of the included meals • Laundry or dry cleaning • Telephone, email, and fax charges • Room service • Other items of a personal nature

AIRFARE

U.S. domestic and international airfare is not included in the program rates. Information about making flight arrangements will be sent to all participants.

WHAT TO EXPECT

June is an excellent time for a Mediterranean cruise. Temperatures and humidity are moderate, rain infrequent, and seas are generally smooth. The pace of this tour is active and all participants should be in good health, physically fit, and capable of walking over rough terrain without assistance from tour staff. Daily programs involve walking of one to two miles, such

as through archaeological sites, from coach drop-off points, in museums, and on city tours—sometimes on uneven terrain including dirt and cobblestoned paths.

GROUP SIZE

The maximum number of participants on this program is 60, including travelers from Princeton University, Yale University, and Smith College.

INSURANCE

Travel insurance for trip cancellation and interruption, medical problems, baggage loss and delay, etc., is highly recommended, and we hope that you will obtain it for this expedition. Trip cancellation policies that apply to this expedition are included in this brochure. Please be sure to carry the details of your travel insurance coverage with you on the program. Travelers are free to purchase the travel insurance of their choice. It is recommended that travelers clearly understand the difference between "primary" and "secondary" travel insurance.

TERMS & CONDITIONS

RESERVATIONS AND DEPOSITS

To reserve space, please complete the reservation form and mail it with your check or credit card information to the address at the top of the form. You may also fax the form to (650) 560-6400 and your reservation will be held for five working days pending receipt of your check or credit card information. If you have questions, please call (888) 328-2089 or email res@critteriontravel.com. Final payment deadline is February 2, 2016, 120 days prior to departure.

CANCELLATIONS AND REFUNDS

Upon payment of a \$1,000 deposit per person, all reservations are subject to the cancellation provisions set forth below and by which the passenger agrees to be bound. Cancellations shall not be effective until they are received in writing and confirmed by Criterion Travel. Deposits are refundable (less a \$250 per person administration fee) if written notice of cancellation is received within 30 days of reservation; after that, deposits are 100% nonrefundable. Final payment is due February 2, 2016 (120 days prior to departure). Cancellations within 120 days of departure are 100% nonrefundable. For this reason, we strongly urge participants to purchase trip cancellation insurance. If the program is cancelled by Criterion Travel, you will receive a full refund, without further obligation on our part. No refunds will be made for any part of this program on which you choose not to

participate. Note: Criterion Travel does not accept liability for any airline cancellation penalty incurred by the purchase of a nonrefundable ticket in conjunction with this tour.

ITINERARY CHANGES

The itinerary presented for this tour is subject to modification and change by Criterion Travel. Every reasonable effort will be made to operate the program as planned; however, should unforeseen world events and conditions require the itinerary to be altered, Criterion Travel reserves the right to do so for the safety and best interest of the group. Any extra expenses incurred in this situation are the responsibility of the participant.

RESERVATION CONTACT

(888) 328-2089 or
res@critteriontravel.com

California Seller of Travel Program
CST #2088800-40

PHOTO CREDITS:

(From Dreamstime.com): Syracuse Harbor © Bensliman Hassan; Acropolis Museum, Athens © Roland Nagy
(From Shutterstock.com): Zeus Temple and Acropolis © Albert Nowicki; Lemons © Flavio Massari; Syracuse Greek Theater © Diego Barucco; Topkapi Palace © Ivo Vitanov; Velinov; Blue Mosque © Galyna Andrushko; Spices © Faraways

NAME #1 (as on passport)	BIRTHDATE
NAME #2 (as on passport)	BIRTHDATE
STREET ADDRESS	
CITY / STATE / ZIP / POSTAL CODE	
HOME PHONE	WORK PHONE
E-MAIL(s)	

PAYMENT

☐ Enclosed is my check for \$ _____ (\$1,000 per person), to reserve _____ place(s) on **Turning Points of History**

OR ☐ Charge the deposit to my credit card (circle one):

VISA MC AMEX Diners Club Discover

NAME ON CREDIT CARD		
CARD #	EXP. DATE	SECURITY CODE
SIGNATURE AS IT APPEARS ON CREDIT CARD		DATE

CATEGORY PREFERENCE

1st Choice _____ 2nd Choice _____

Bed Preference (not guaranteed): ☐ One bed ☐ Two beds

SINGLE TRAVELERS

☐ I prefer to have single accommodations.

OR ☐ I plan to share accommodations with:

OR ☐ I'd like to know about roommates.

I am a ☐ Non-smoker ☐ Smoker.

I understand that if a roommate cannot be found by the final payment deadline of February 2, 2016, I will pay the single rate.

☐ I/We have read the Terms & Conditions section of this brochure and understand and agree with them as stated herein.

SIGNATURE	DATE
SIGNATURE	DATE